

PRODUCT FEATURES

DELTA is a double flap smoke vent suitable for the removal of large quantities of warm air and / or smoke from a building within a short period of time, daily ventilation and natural lighting. Suitable for utilization on various kerbs and domes. The vents are manufactured according to ISO 9001 quality control standards and comply with the European requirements for NSHE according to EN 12101-2. Endurance tests with 10,000 opening and closing cycles have proven its robust and functional design. The vents are formed from high quality corrosion resistant aluminium to ensure low maintenance requirements and watertightness. Various methods of operation using pneumatic or electric actuators are available. Available on large dimensions, up to 2500 x 3500 mm (width x length).

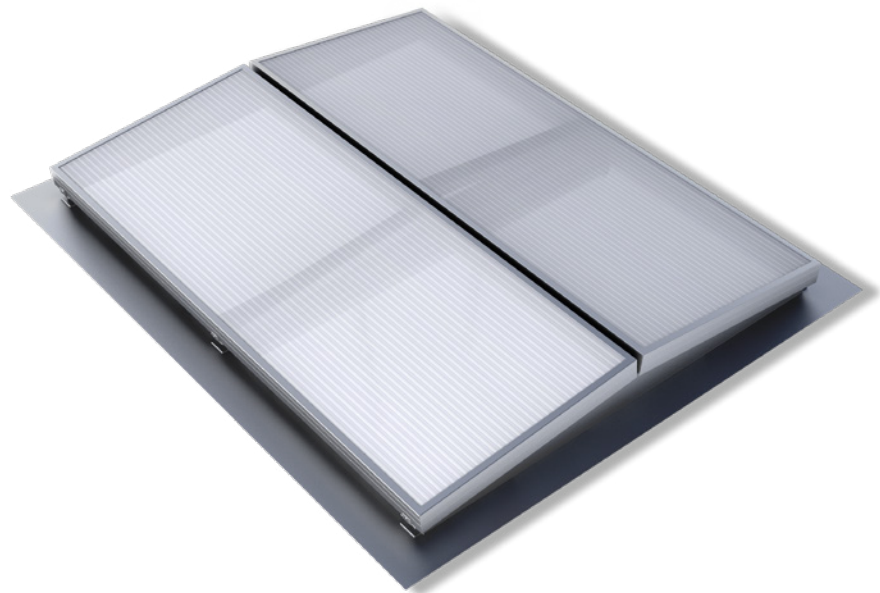



delta

TYPICAL APPLICATIONS

Particularly suitable for warehouses; logistics centres, production environments and over stairwells.

- Flat roofs
- Skylights
- on to Builders up-stand
- Profiled metal roof sheeting

MATERIALS

Aluminium; tempered, sea water and corrosion-resistant AlMg3 and extruded aluminium profiles for the frames. Corrosion-resistant bearings. The aluminium is supplied untreated as standard. Free of silicones.

DIMENSIONS

Roof opening width W: 1000 - 2500 mm
Roof opening length L: 1000 - 3500 mm

OPENING ANGLE

Individual adjustable from 0° up to 90°

CONTROLS NATURAL VENTILATION

P2 - Double pipe compressed air operation
M230V Electric motor

CONTROLS FIRE VENTILATION

P2F double pipe compressed air operation with fire function
M24/48V Electric motor

FLAPS

AL	Single aluminium
AL ISO	Thermally insulated aluminium
PC16	Polycarbonate 16mm, clear or opal
PC25	Polycarbonate 25mm, clear or opal
PC32	Polycarbonate 32mm, clear or opal
TB	Thermal break in the aluminium profiles. Available for flaps of AL ISO, PC25 mm, PC32 mm

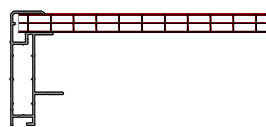

PC16

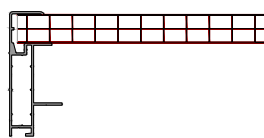

PC25

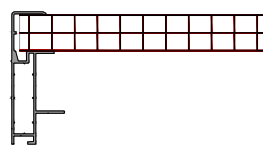

PC32

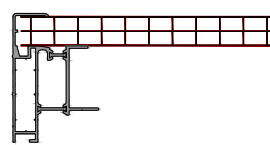

PC25 TB

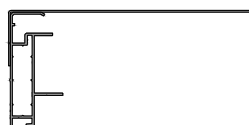

AL



AL ISO 20

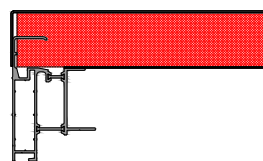

TB AL ISO 50

BASES

Single aluminium

Double insulated aluminium

Double insulated aluminium and TB, thermal break in the aluminium base

Other non-standard bases available upon request

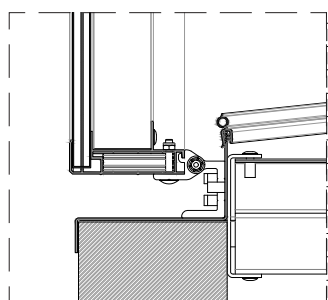

DETAIL 01
standard aluminium

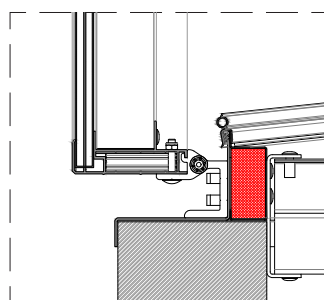

DETAIL 02
insulated aluminium

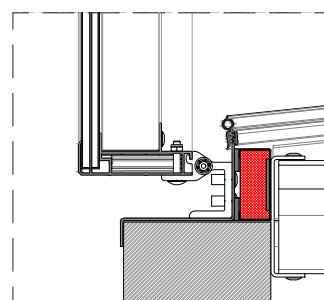

DETAIL 03
double insulated aluminium
and TB

FLANGES

S1	Flange for single glass
S2	Flange for double glass
S3	Flange for roofs, 45° bended
S4	Flange for roofs and facades
S5	Flange for upstand, 90° bended downwards
S6	Flange 90° bended upwards
SLS	Flange for skylight connection, for different polycarbonate thicknesses
SC	Flange for connection with other flange (vents connection). Male or female connection.
SCM	Flange for male connection
SCF	Flange for female connection

* Custom flange design and insulated flanges upon request

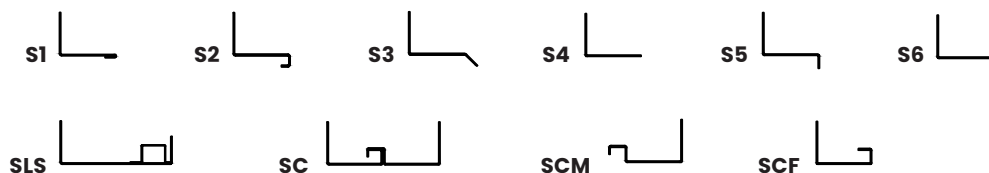

WEIGHT

Depends on dimensions and type of infill

OPTIONS

Custom dimensions / Powder-coated design (any RAL colour) /
Bird or insect mesh/ Anti-fall grid 1200 J.

REGULATIONS

The system has been tested and is certified in accordance with EN 12101-2

STANDARD INTERIOR DIMENSIONS

TYPE	1010	1015	1020	1025	1030	1035	1510	1515	1520	1525	1530	1535
WIDTH (MM)	1000						1500					
LENGTH (MM)	1000	1500	2000	2500	3000	3500	1000	1500	2000	2500	3000	3500

TYPE	2010	2015	2020	2025	W2030	2035	2510	2515	2520	2525	2530	2535
WIDTH (MM)	2000						2500					
LENGTH (MM)	1000	1500	2000	2500	3000	3500	1000	1500	2000	2500	3000	3500

DRIVE SUPPORT

1000 UP TO 1700



1701 UP TO 2500

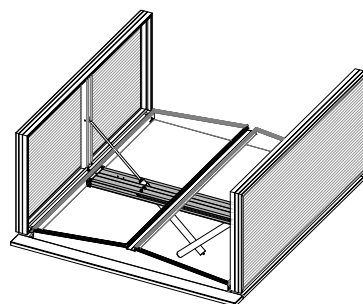

GENERAL DRAWINGS | DELTA

DELTA

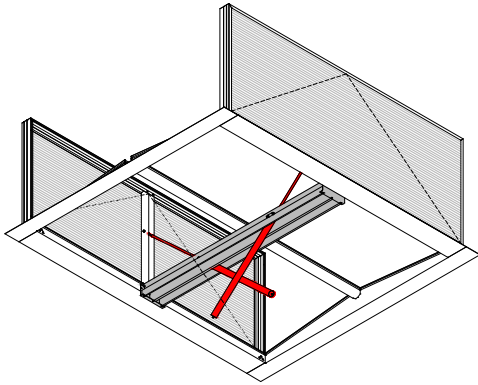

BOTTOM PERSPECTIVE VIEW OPEN
OPENING SYSTEM

DELTA S

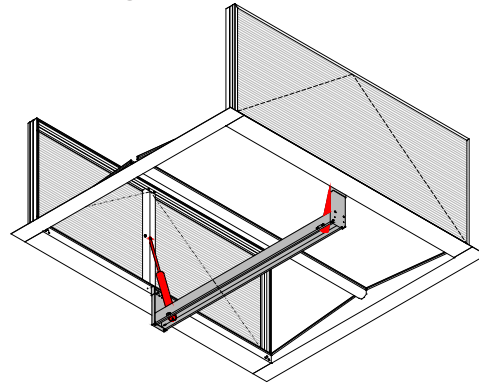

BOTTOM PERSPECTIVE VIEW OPEN
OPENING SYSTEM

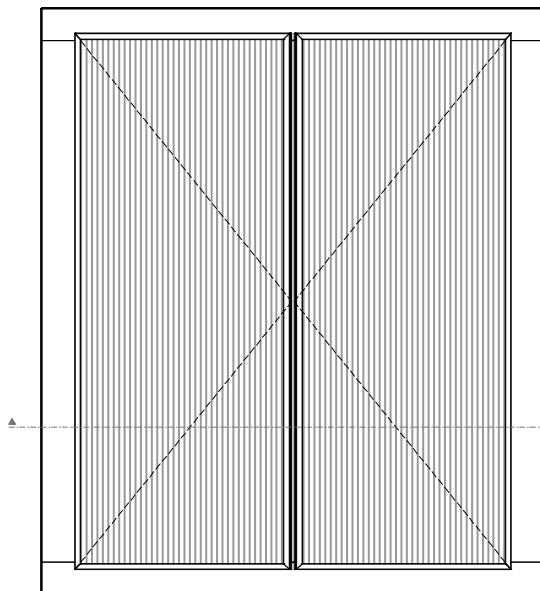

SECTION S1

DIMENSION DRAWING FOR DELTA INSTALLATION

WIDTH	DRIVE	X	Y	Z
1000 - 1700	P2F - 575	427	660	162
	M24V - 575	427	630	-
1701 - 2500	P2F - 800	598	890	162
	M24V - 800	598	830	-

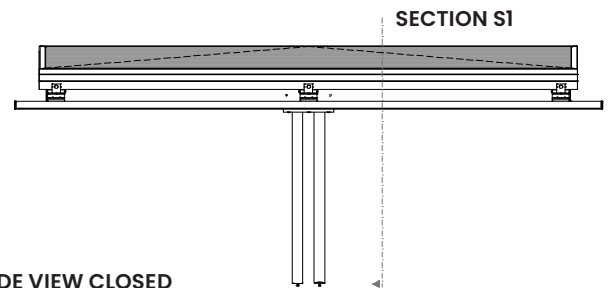

SIDE VIEW CLOSED

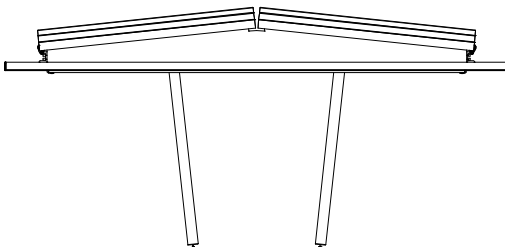

FRONT VIEW CLOSED

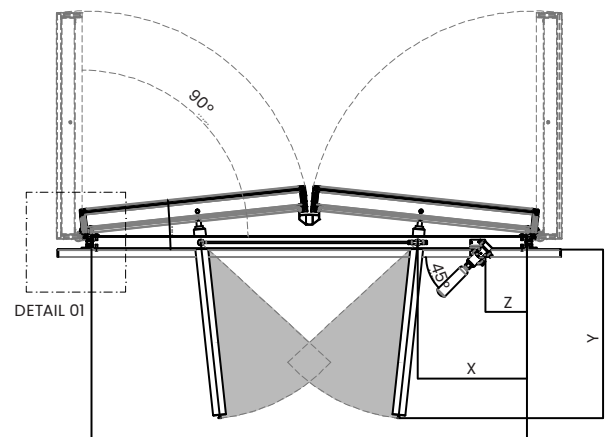

SECTION S1

WIDTH