

## PRODUCT FEATURES

MEGADELTA is a double flap vent suitable for all-weather ventilation of warm air and / or smoke from a building within a short period of time, daily ventilation and natural lighting. It is equipped with lateral inner flaps to enable weather-protected ventilation. As soon as the outer flaps close due to rain, the inner flaps open. The flaps are closed by a spring mechanism. The changeover from fair-weather ventilation to weather-protected ventilation is controlled by a rain-sensor system. Suitable for utilization on various kerbs and domes. The vents are manufactured according to ISO 9001 quality control standards and comply with the European requirements for NSHE according to EN 12101-2. Endurance tests with 10,000 opening and closing cycles have proven its robust and functional design. The vents are formed from high quality corrosion resistant aluminium to ensure low maintenance requirements and water tightness. Various methods of operation using pneumatic or electric actuators are available. Available on large dimensions, up to 1900 x 3000 mm (width x length).

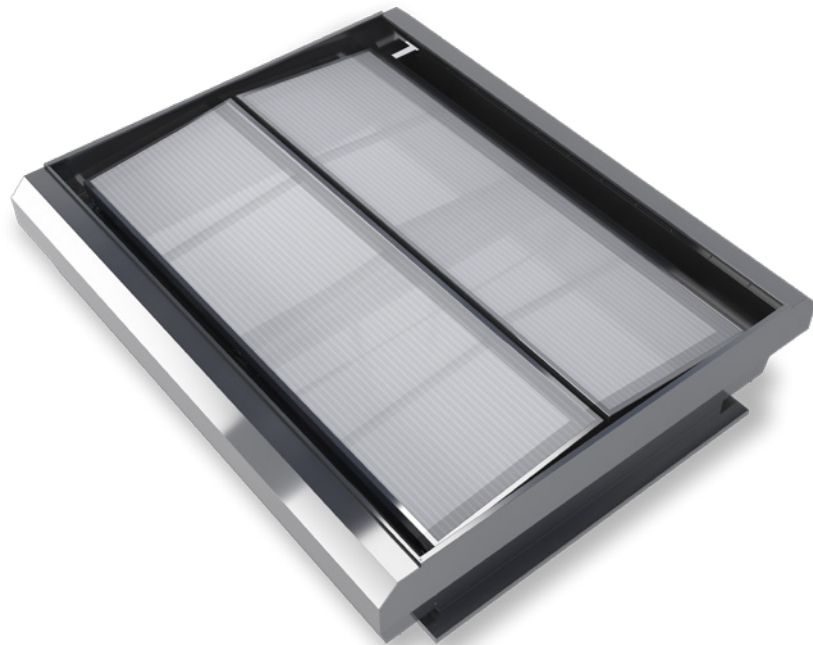

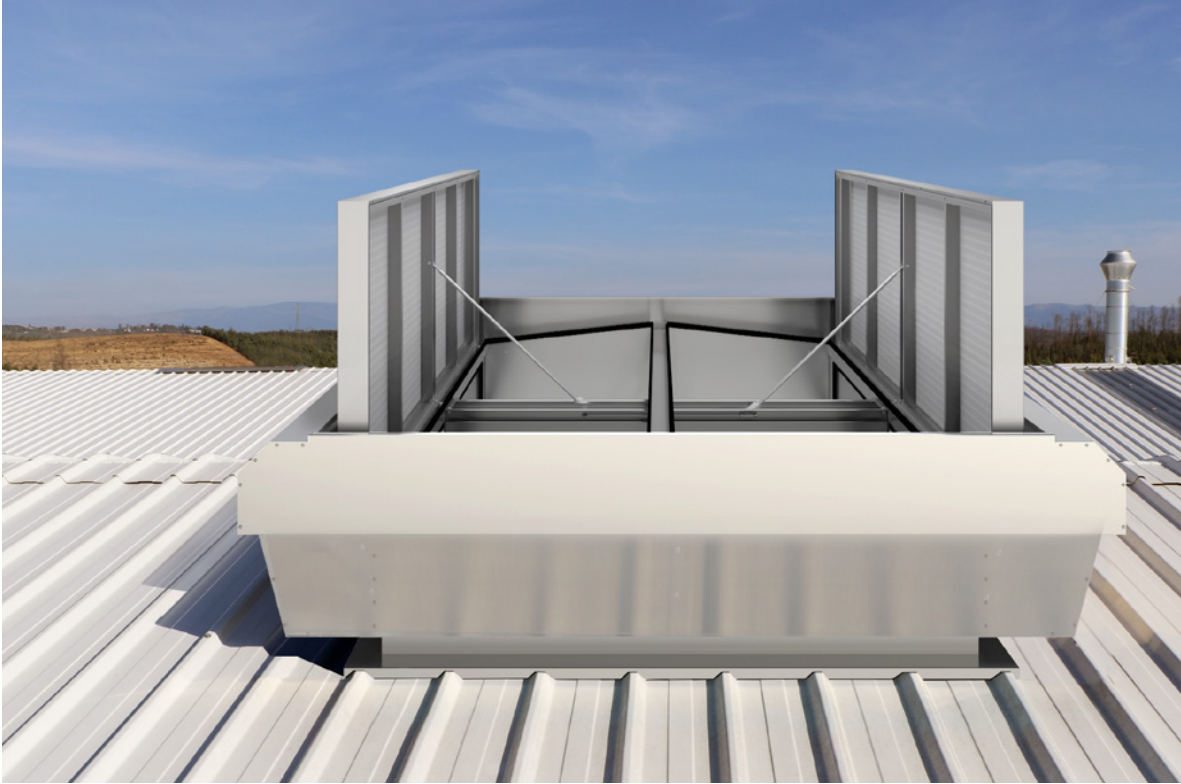

# megadelta

## TYPICAL APPLICATIONS

May be installed either onto roofs or into barrel vault daylighting systems. Particularly suitable for warehouses; logistics centres, production environments and industries.

- Flat roofs
- Skylights
- Northlight roofs

## MATERIALS

Aluminium; tempered, sea water and corrosion-resistant AlMg3 and extruded aluminium profiles for the frames. Corrosion-resistant bearings. The aluminium is supplied untreated as standard. Free of silicones.

## DIMENSIONS

Roof opening width W: 1000 - 1900 mm  
Roof opening length L: 1000 - 3000 mm

## OPENING ANGLE

Individual adjustable from 0° up to 90°

## CONTROLS NATURAL VENTILATION

P2 - Double pipe compressed air operation  
M230V Electric motor

## CONTROLS FIRE VENTILATION

P2F double pipe compressed air operation with fire function  
M24/48V Electric motor

## FLAPS

- AL** Single aluminium
- AL ISO** Double insulated aluminium (20 and 50 mm)
- PC16** Polycarbonate 16mm, clear or opal
- PC25** Polycarbonate 25mm, clear or opal
- PC32** Polycarbonate 32mm, clear or opal
- TB** Thermal break in the aluminium profiles. Available for flaps of AL ISO, PC25 mm, PC32 mm



**PC16**

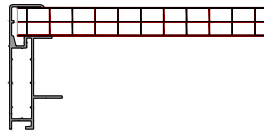

**PC25**

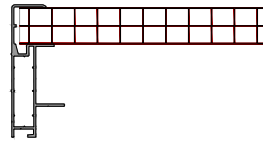

**PC32**

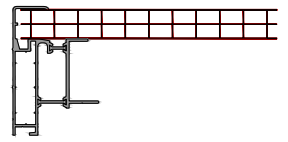

**PC25 TB**

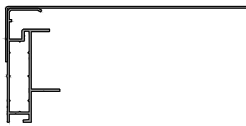

**AL**



**AL ISO 20**

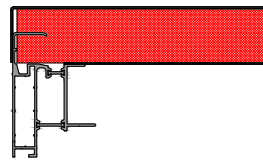

**TB AL ISO 50**

## BASES

- Single aluminium
- Double insulated aluminium
- Double insulated aluminium and TB, thermal break in the aluminium base
- Other non-standard bases available upon request

## FLANGES

- S1** Flange for single glass
- S2** Flange for double glass
- S3** Flange for roofs, 45° bended
- S4** Flange for roofs and facades
- S5** Flange for upstand, 90° bended downwards
- S6** Flange 90° bended upwards
- SLS** Flange for skylight connection, for different polycarbonate thicknesses
- SC** Flange for connection with other flange (vents connection). Male or female connection
- SCM** Flange for male connection
- SCF** Flange for female connection

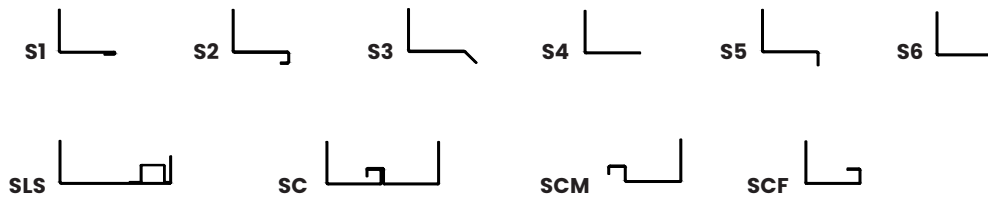

## WEIGHT

Depends on dimensions and type of infill

## OPTIONS

Custom dimensions / Powder-coated design (any RAL colour) / Bird or insect mesh/Anti-fall grid 1200 J.

## REGULATIONS

The system has been tested and is certified in accordance with EN 12101-2

## STANDARD INTERIOR DIMENSIONS

TYPE	1010	1015	1020	1025	1020	1310	1315	1320	1325	1330
WIDTH (MM)	1000					1250				
LENGTH (MM)	1000	1500	2000	2500	3000	1000	1500	2000	2500	3000
TYPE	1510	1515	1520	1525	1530	1910	1915	1920	1925	1930
WIDTH (MM)	2000					1900				
LENGTH (MM)	1000	1500	2000	2500	3000	1000	1500	2000	2500	3000

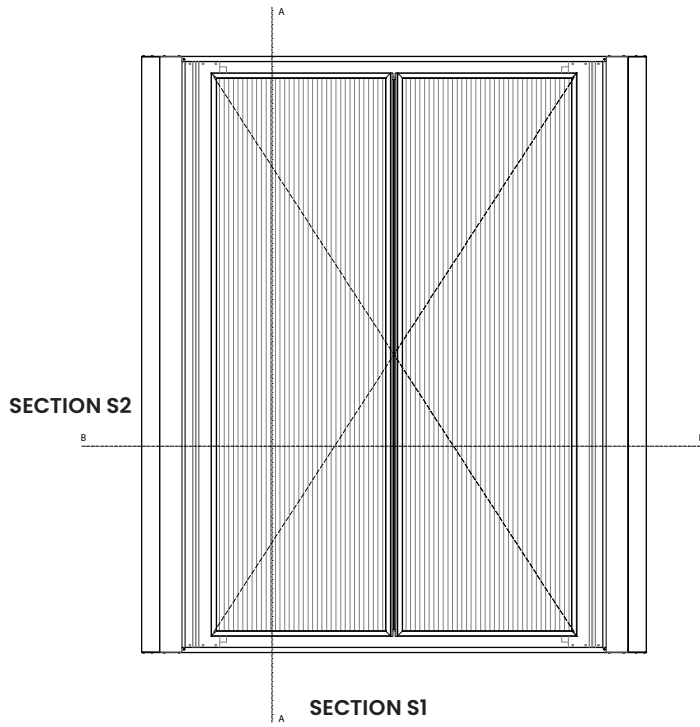

TOP VIEW

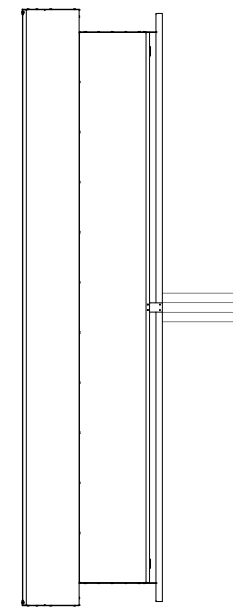

SECTION S1  
SIDE VIEW CLOSED

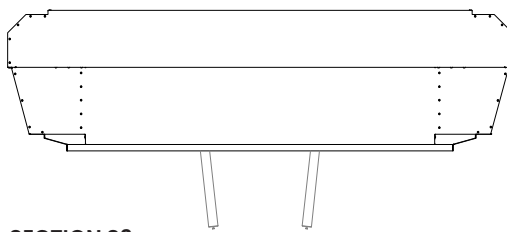

SECTION S2  
FRONT VIEW CLOSED

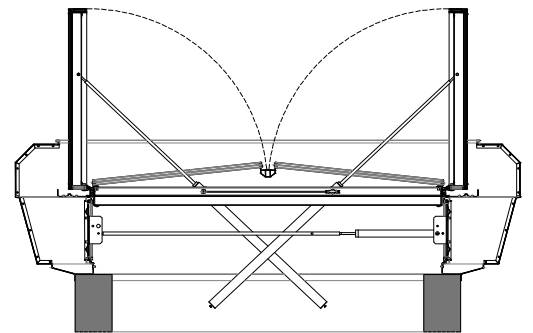

FRONT VIEW OPEN

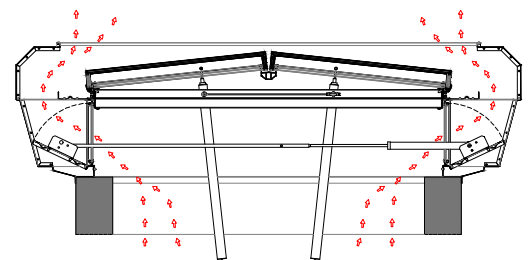

CLOSED VENT | OPENED VENTILATION

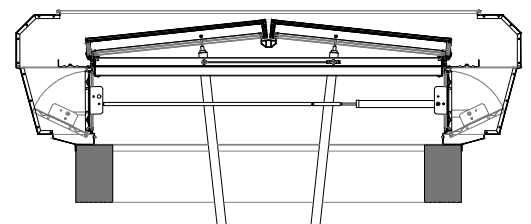

CLOSED VENT | CLOSED VENTILATION